

UNIVERSAL 1-BOLT COMB LUGS

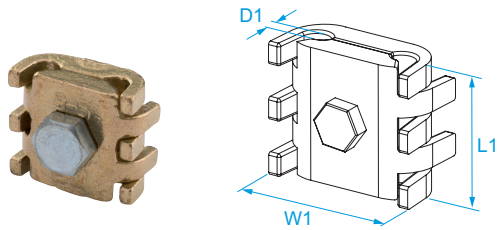

MATERIAL: die-cast brass

SECTION: main and derived conductor of the same section

OPERATING TEMPERATURE: da -50 °C a +150 °C

APPLICATIONS: grounding systems, to connect copper wire ropes or copper conductors suitable for earthing

Code	Section (mm ²)	Cable diameter (mm)	D1 (mm)	W1 (mm)	L1 (mm)	Screw	
5251	6 ÷ 16	3 ÷ 5	5	25,5	20,5	M6	100/100
5252	25 ÷ 50	6 ÷ 8	9	29,5	25	M8	50/50
5253	50 ÷ 70	9 ÷ 12	12	37,5	30	M8	50/50

UNIVERSAL 2-BOLT COMB LUGS

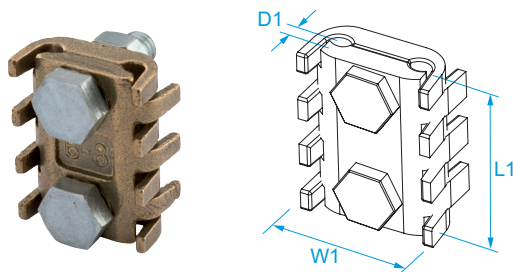

MATERIAL: die-cast brass

SECTION: main and derived conductor of the same or different section

OPERATING TEMPERATURE: da -50 °C a +150 °C

APPLICATIONS: grounding systems, to connect copper wire ropes or copper conductors suitable for earthing

Code	Section (mm ²)	Cable diameter (mm)	D1 (mm)	W1 (mm)	L1 (mm)	Screw	
5261	6 ÷ 16	3 ÷ 5	5	25	32	M6	100/100
5262	25 ÷ 50	6 ÷ 8	9	32	38	M6	100/100
5263	50 ÷ 70	9 ÷ 12	12	42	45	M8	50/50
5264	70 ÷ 95	12 ÷ 14	14	53	53	M10	25/25
5265	95 ÷ 150	14 ÷ 16	16	54,5	57,5	M10	20/20
5266	150 ÷ 300	16 ÷ 22	22	66	67	M12	10/10

CONNECTION TYPES

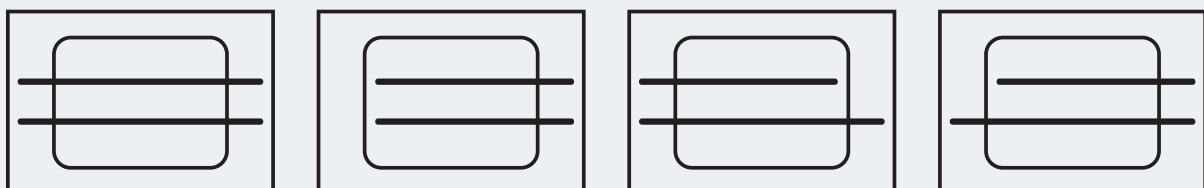

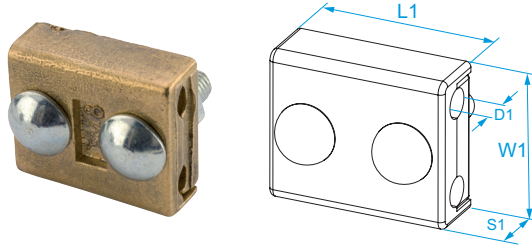
TWO-WIRE DIAMOND LUGS

MATERIAL: die-cast brass

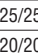
OPERATING TEMPERATURE: da -50 °C a +150 °C

Code	Section (mm ²)	D1 (mm)	W1 (mm)	L1 (mm)	S1 (mm)	Screw	
5211	6	3	19	23	8	M5	100/100
5212	10	4	20	27	9,5	M5	100/100
5213	16	5	24	29,5	10,75	M6	100/100
5214	25	6	27	34,5	11,5	M6	50/50
5215	35	7	30	36	11,5	M6	50/50
5216	40	8	33,5	39,5	14	M8	25/25
5217	50	9	35,5	43	15	M8	25/25
5218	63	10	37,5	47,5	16	M10	25/25
5219	70	11	43,5	53	17,5	M10	25/25
5220	80	12	46,5	56	18	M10	25/25
5221	95	13	46,5	56	18	M10	20/20
5222	120	14	50	58,5	18,5	M10	10/20
5223	135	15	50	58,5	18,5	M10	10/10

1-BOLT EARTHING LUGS

MATERIAL: die-cast brass

OPERATING TEMPERATURE: da -50 °C a +150 °C

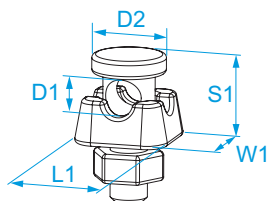

Code	Section (mm ²)	D1 (mm)	D2 (mm)	W1 (mm)	L1 (mm)	S1 (mm)	Screw	
22	50	10	21	26	26,5	41	M10	100/100

2-BOLT EARTHING LUGS

MATERIAL: die-cast brass

OPERATING TEMPERATURE: da -50 °C a +150 °C

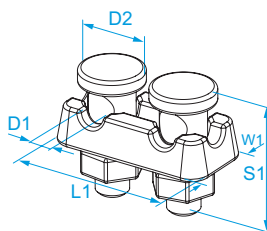

Code	Section (mm ²)	D1 (mm)	D2 (mm)	W1 (mm)	L1 (mm)	S1 (mm)	Screw	
23	50	10	21	26	51,5	41	M10	25/50

1-BOLT TERMINALS

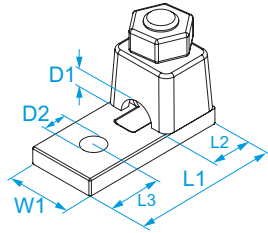

MATERIAL: nickel-plated die-cast brass

OPERATING TEMPERATURE: da -50 °C a +150 °C

Code	Section (mm ²)	Cable diameter (mm)	For screw Ø screw (mm)	For screw Stud size	D1 (mm)	D2 (mm)	W1 (mm)	L1 (mm)	L2 (mm)	L3 (mm)	Screw	
5160	4 ÷ 10	2 ÷ 4	5	#10	4,2	5,25	12	26,5	12	7	M5	100/100
5161	10 ÷ 25	4 ÷ 6	5	#10	6,2	6	14	36	11	8	M6	100/100
5162	25 ÷ 35	6 ÷ 8,5	5	#10	8,5	6	17	38	12,5	8	M7	100/100
5163	35 ÷ 50	8,5 ÷ 11	7	9/32"	11,5	8,3	23	50	18	12	M10	50/50
5164	70 ÷ 95	11 ÷ 14	10	3/8"	15	10,5	26,5	55	20,5	14,5	M12	25/25
5165	95 ÷ 120	14 ÷ 17	10	3/8"	27,5	11,5	32	64	23	16	M14	25/25
5166	150 ÷ 185	17 ÷ 20,5	14	9/16"	21	14	37,5	79	26	18	M16	20/20
5167	185 ÷ 240	20,5 ÷ 24	16	5/8"	24	17	40	94	31,5	23	M16	10/20

2-BOLT TERMINALS

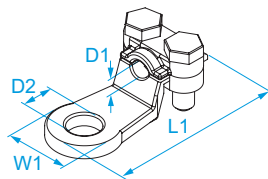

MATERIAL: nickel-plated die-cast brass

OPERATING TEMPERATURE: da -50 °C a +150 °C

Code	Section (mm ²)	For screw Ø screw (mm)	For screw Stud size	D1 (mm)	D2 (mm)	W1 (mm)	L1 (mm)	Screw	
5140	10	5	#10	4	6	15	32,5	M5	100/200
5141	16	8	5/16"	5,1	8,5	17	37	M5	200/200
5142	25	8	5/16"	6,3	6,3	18,75	42	M5	150/150
5143	35	10	3/8"	7,5	7,5	21,5	49	M5	100/100

4-BOLT TERMINALS

MATERIAL: nickel-plated die-cast brass

OPERATING TEMPERATURE: da -50 °C a +150 °C

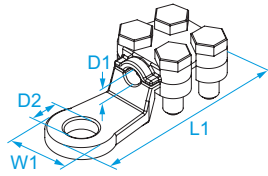

Code	Section (mm ²)	For screw Ø screw (mm)	For screw Stud size	D1 (mm)	D2 (mm)	W1 (mm)	L1 (mm)	Screw	
5144	50	10	3/8"	9,5	10,5	23	56,5	M6	100/200
5145	75	12	1/2"	11	13,25	26	61	M6	50/50
5146	100	12	1/2"	13	14,3	29	65	M6	50/50
5147	120	14	9/16"	14	14,8	32	71	M6	50/50
5148	170	14	9/16"	16	16	33	81	M8	25/25
5149	200	16	5/8"	17	17	35	85	M8	25/25
5150	250	16	5/8"	18	17	38	87,5	M8	25/25
5151	300	18	13/16"	21	19,8	45	118	M10	15/15
5152	400 ÷ 500	22	7/8"	25,5	22	53	132	M10	10/10
5153	700	22	7/8"	34	22	60	150	M10	1/1

“U” HEAD CONNECTORS

MATERIAL: nickel-plated die-cast brass

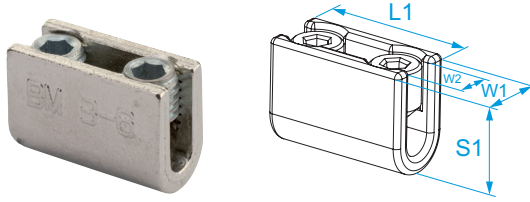

Code	Section (mm ²)	Cable diameter (mm)	W1 (mm)	W2 (mm)	L1 (mm)	S1 (mm)	Screw	
2300	4 ÷ 16	2 ÷ 4,5	10,25	5	23	15,25	M7	100/100
2301	10 ÷ 25	3 ÷ 6	14	6,5	30	20	M10	100/100
2302	25 ÷ 35	7 ÷ 8	17	8,25	42	22,5	M12	50/50
2303	35 ÷ 70	9 ÷ 10	19,5	10,3	51	26	M14	50/50
2304	70 ÷ 95	11 ÷ 13	27	13,5	71	30	M20	10/10
2305	95 ÷ 185	14 ÷ 16	31	16	73	38	M24	10/10

“T” HEAD CONNECTORS

MATERIAL: nickel-plated die-cast brass

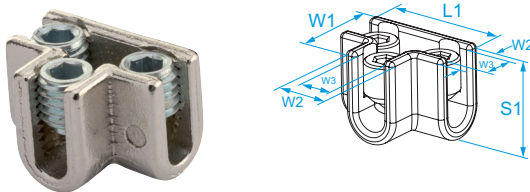

Code	Section (mm ²)	Cable diameter (mm)	W1 (mm)	W2 (mm)	W3 (mm)	L1 (mm)	S1 (mm)	Screw	
2350	4 ÷ 16	2 ÷ 4,5	16,75	10,75	5	23	15,5	M7	100/100
2351	10 ÷ 25	3 ÷ 6	22	13,75	7	30	20	M10	100/100
2352	25 ÷ 35	7 ÷ 8	31,5	17	8,15	42,5	22,5	M12	50/50
2353	35 ÷ 70	9 ÷ 10	36	19,5	10	52	25,5	M14	25/50
2354	70 ÷ 95	11 ÷ 13	50	27	13	71	30	M20	10/10
2355	90 ÷ 185	14 ÷ 16	53	32	16,25	72	38	M24	10/10