

Product family: Terminals - Insulated quick-connect terminals
Item code: 80195, 80295
Description: QUICK-CONNECT TERMINALS · NYLON INSULATED · TOTALLY INSULATED FEMALE · FLAG TYPE

Image

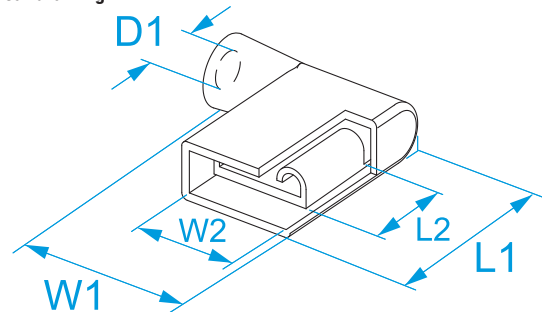

Technical drawing



Specifications

TERMINAL MATERIAL: tinned brass
INSULATION MATERIAL: polyamide (PA 6.6)
OPERATING TEMPERATURE: 105 °C max
INSULATION SELF-EXTINGUISHING GRADE: UL 94 V2
RATED VOLTAGE: 300V max
HOW TO ASSEMBLE: double crimping

Code	Color	Section (mm ²)	Section (AWG/MCM)	For male (mm)	For male (")	W1 (mm)	W2 (mm)	L1 (mm)	L2 (mm)	D1 (mm)	
80195		0.5 ÷ 1.5	(20 - 16)	6.3 x 0.8	0.250x0.032	15	6,6	16	7,9	4	100/1000
80295		1.5 ÷ 2.5	(16 - 14)	6.3 x 0.8	0.250x0.032	15	6,6	16	7,9	4,5	100/1000

