

**Product family:** Terminals - Insulated connectors  
**Item code:** 80160, 80260, 80360, 80460, 80560, 80660  
**Description:** BUTT CONNECTORS · NYLON INSULATED

**Image**

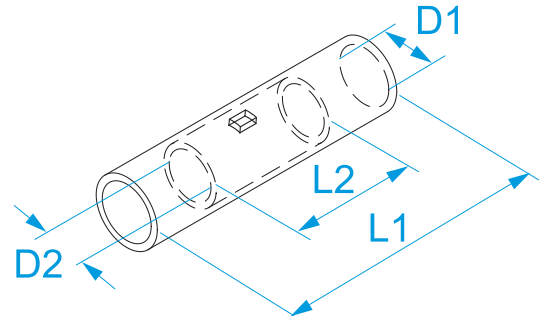







**Technical drawing**



**Specifications**

**TERMINAL MATERIAL:** tinned copper  
**INSULATION MATERIAL:** polyamide (PA6.6)  
**INSULATION** UL 94 V2  
**SELF-EXTINGUISHING GRADE:**  
**OPERATING TEMPERATURE:** 105 °C max  
**MAX RATED VOLTAGE:** 300  
**TYPE:** with central flush for a right insertion of the conductor.

Code	Color	Section (mm <sup>2</sup> )	Section (AWG/MCM)	L1 (mm)	L2 (mm)	D1 (mm)	D2 (mm)	
80160*		0.25 ÷ 1.5	(22 - 16)	26	15	3,4	1,7	100/1000
80260*		1.5 ÷ 2.5	(16 - 14)	27	15	4,1	2,4	
80360*		4 ÷ 6	(12 - 10)	28	15	5,6	3,6	50/500
80460		10	(8)	43	26	8,2	4,8	
80560		16	(6)	46	29	9	6	100/100
80660		25	(4)	46	29	11,5	7	

 \* file n° E 137735

 105 °C