

Product family: Brass cable glands - PG thread
Item code: 4206, 4213, 4220, 4228, 4238
Description: ACCESSORIES FOR BRASS CABLE GLANDS: IP68 STOP-ENDS

Image

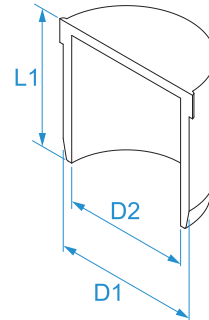

Technical drawing



Specifications

MATERIAL: red polyamide
OPERATING TEMPERATURE: from -40 °C to +100 °C
APPLICATIONS: suitable to close IP68 nylon and brass cable gland holes
ASSEMBLY: insert the plug with the end-stop wings on the cable gland gasket and tighten
TIGHTENING TORQUE: 1 N/m

Code	D1 (mm)	D2 (mm)	L1 (mm)	Suitable for cable glands with thread Metric	Suitable for cable glands with thread PG	
4206	6	2,8	16	M12 M16 M20	PG7 PG9 PG11 PG13.5	50/1750
4213	13	8,5	22	M25	PG16 PG21	
4220	20	14,5	22	M32 M40	PG29	25/875
4228	28	22	30		PG36	
4238	38	32	35	M50 M63	PG42 PG48	10/350

IP68